



**straumann**



*Fodder mixing wagon*

## **Verti-Mix 400/500**



# Verti-Mix 400 / 500

## Small mixture with big effect

### Discharge via side door

enables simultaneous discharge on both sides



### Easy access

by means of folding steps at the rear

- Optimum control
- Easy adding of small quantities of fodder



### Drawbar available with top or bottom hitch

- Easy height adjustment by means of hole pattern

### Mechanical supporting leg,

hydraulic version as an optional extra

### Homogeneous mixing by means of Vario mixing auger

The Vario mixing auger – Variability and strength for any purpose

Due to the patented knife adjustment system, the Vario mixing auger can be perfectly adapted to your specific conditions of use. The robust and low-maintenance angular gear ensures long service life even under challenging conditions.

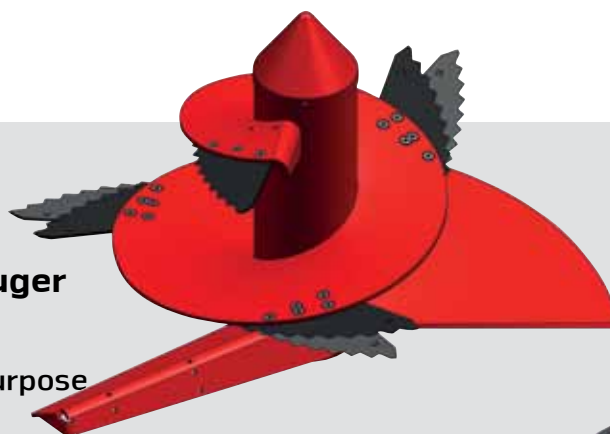

### Special knife options

auger even better to

Bale cutting knife:

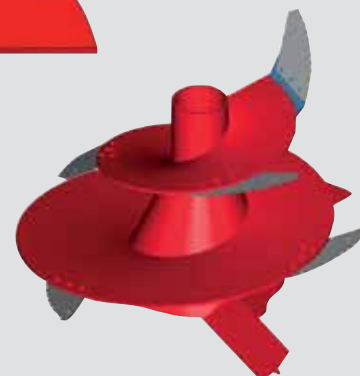

### Attachment (15 cm) available as an optional extra

- Mounted by the manufacturer or available as a retrofit kit
- Increases the mixing capacity



### Weighing & operating



- PTM HL 50**
- Programmable weighing device
  - 50 recipes
  - 30 ingredients



- Radio remote control PTM AV 50**
- Matching the PTM HL 50
  - Up to 30 m of range



**Direct tractor connection**  
Requires one double-acting control device at the tractor for each function



**Operation via Bowden cable**  
One double acting control device at the tractor or one single-acting control device with free return line required



**Electrical control set**  
One double acting control device at the tractor or one single-acting control device with free return line required

## Fodder mixing wagon Verti-Mix 400/500

### Technical data

Type		Verti-Mix 400	Verti-Mix 500
<b>Dimensions</b>			
Length	m	3,62	3,62
Width			
- with one-sided discharge	m	1,79	1,79
- with two-sided discharge	m	1,88	1,88
Height	m	1,92	2,18
Wall thickness	mm	6	6
Bottom plate	mm	12	12
Track	m	1,35	1,35
Outside wheel width	m	1,62	1,62
Usable mixing capacity*	m <sup>3</sup>	4,0	5,0
<b>Dead weight*</b>			
- one-sided discharge	kg	1.560	1.600
- two-sided discharge	kg	1.660	1.700
Gross vehicle weight	kg	3.000	3.000
Tongue load	kg	850	1.000
Axle load	kg	2.150	2.500
Discharge height	m	0,58	0,58
Power required	kW/PS	26 / 35	26 / 35

\* Actually usable mixing capacity, augers having been deducted from the capacity

help to adapt your Vario mixing wagon to your needs:

Straw knife (long/short):

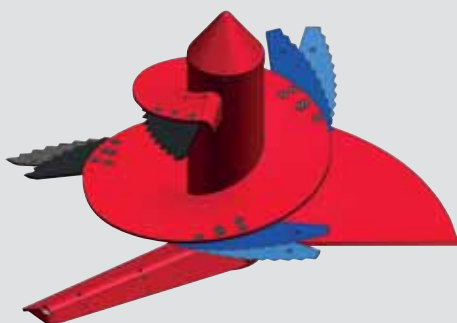





# strautmann



Strautmann main production facility in Bad Laer

B. Strautmann & Söhne GmbH u. Co. KG is a medium-sized family-owned company from southern Lower Saxony having already celebrated its 80th anniversary of existence and now being managed by the third generation. In a modern plant at the second production site in Lwówek (Poland), Strautmann manufactures individual machine components and, apart from that, also parts of the

machine programme such as tipping trailers, silage shovels or shear grabs. As a machine manufacturer offering a wide range of machinery for cattle feeding, green fodder harvesting, universal spreader and transport technology as well as in the field of charging and dosing technology for biogas plants Strautmann is the suitable partner for almost any customer in this industry.



Pol-Strautmann



001 / 04.2014

**B. Strautmann & Söhne GmbH u. Co. KG**

Bielefelder Straße 53 · D-49196 Bad Laer · Tel.: +49(0)5424/802-0 · Fax: +49(0)5424/802-76 · info@strautmann.com · www.strautmann.com